

SUBMITTAL

Part Number
2010645

SUBMITTED TO _____

COMPANY _____

JOB NAME _____

EQUIPMENT _____

SIGNATURE _____

DATE _____

© 2007 COX ENGINEERING DBA CAMBRIDGEPORT AIR SYSTEMS.
THE INFORMATION CONTAINED IN THIS DOCUMENT IS PROPRIETARY TO
COX ENGINEERING COMPANY DBA CAMBRIDGEPORT AIR SYSTEMS.
THIS DOCUMENT OR THE INFORMATION CONTAINED IN WHOLE OR IN PART
MAY NOT BE ISSUED TO ANOTHER PARTY WITHOUT WRITTEN CONSENT AND
AUTHORIZATION FROM CAMBRIDGEPORT.

SUBMITTAL

| REVISIONS | | | |
|-----------|------|-------------|----------|
| ZONE | REV. | DESCRIPTION | DATE |
| | | | APPROVED |

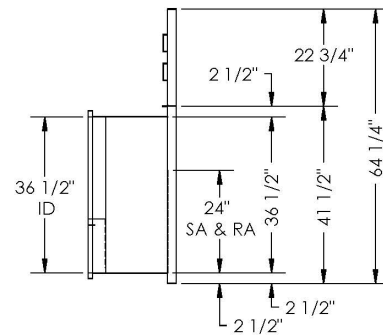
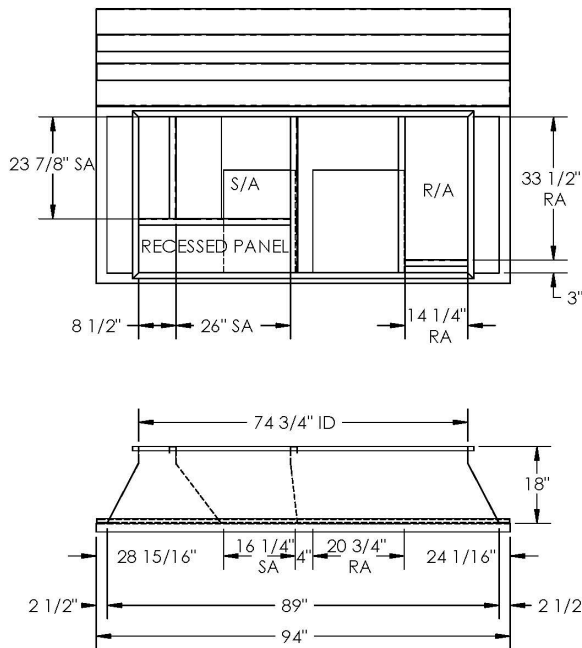

FEATURES:

1. ONE PIECE WELDED CONSTRUCTION
2. CURB ADAPTER MADE OF HEAVY GAUGE GALVANIZED STEEL.
3. ALL WELDS ARE COATED WITH A GALVANIZED COMPOUND.
4. GASKETING IS PROVIDED FOR UNIT TO CURB ADAPTER SEALING.
5. CURB ADAPTER IS FULLY INSULATED.
6. SUPPLY TRANSITION AND RETURN PLENUM INCLUDED.
7. BLANK-OFF PANEL SHIPPED LOOSE FOR FIELD INSTALLATION.

Approved By: _____

Date: _____

MATERIAL: 18GA,(0.0516) 217.9 LBS.

FEATURES

- ONE PIECE WELDED CONSTRUCTION
- FACTORY INSTALLED SUPPLY TRANSITIONS
- FULLY INSULATED
- DESIGNED FOR EVEN WEIGHT DISTRIBUTION
- FABRICATED OF HEAVY GAUGE G90 GALVANIZED STEEL
- ALL WELDS SPRAYED WITH GALVANIZING COMPOUND
- GASKET PROVIDED FOR UNIT TO ADAPTER SEALING

| | | | | | | | |
|--|--|---|--|----------------|--|---|--|
| Cambridgeport | | NORTH 8 Farnham Drive Salem, MA 01962 | | 1-800-648-2872 | | SOUTH 2529 Lamar Ave. Lamar Industrial Park Memphis TN 38119 | |
| HVAC Accessories & Engineered Systems | | | | | | | |
| UNLESS OTHERWISE SPECIFIED: | | CUSTOMER: H.C. NYE COMPANY, INC. | | DRAWN: RTO | | DESCRIPTION: | |
| TOLERANCES: | | CUSTOMER: YORK D3CG102 | | DATE: 8/8/11 | | ASS'Y, ADAPTER | |
| DECIMALS = ± .003 | | UNIT: NEWAON RN-007 | | | | | |
| ANGLES = ± 1° | | SUBMITTAL: MA22955 | | | | | |
| MATERIAL CONDITIONS: | | DETAIL OF: 2010645 | | SHEET 1 OF 1 | | PART NO. 2010645 | |
| REMOVE ALL BURRS & SHARP EDGES | | | | | | REV. | |
| ALL DIMENSIONS ARE O.D. | | | | | | | |

CAMBRIDGEPORT STRONGLY RECOMMENDS CONFIRMING THE DIMENSIONS ON THIS SUBMITTAL

CURB ADAPTERS ARE BASED ON UNIT MANUFACTURERS STANDARD CURB DIMENSIONS.
CAMBRIDGEPORT CANNOT BE RESPONSIBLE FOR ANY DEVIATIONS FROM FACTORY DIMENSIONS OR INCORRECT MODEL NUMBERS.